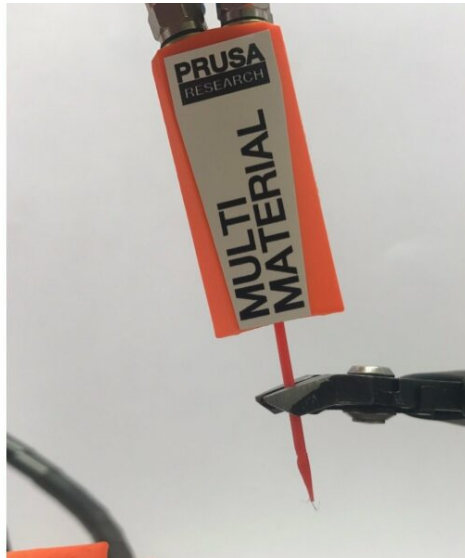

Table of Contents

Unable to unload filament MMU1	3
Step 1 - Remove Festo fitting	4
Step 2 - Check filament in cooling tube	4
Step 3 - Check smooth entry of filament	5
Step 4 - Filament stuck below multiplexer	5

Unable to unload filament MMU1



help.prusa3d.com/g109168

Scan the QR code to
display the latest
version of this
chapter.



STEP 1 Remove Festo fitting

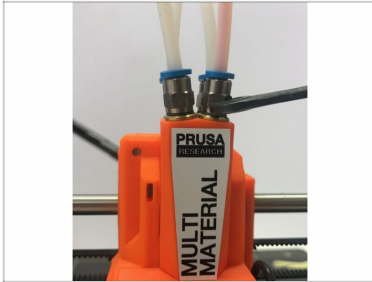

- Remove Festo fittings from multiplexer.
- i** Use the 8mm side of the wrench, which is part of the upgrade kit.

STEP 2 Check filament in cooling tube

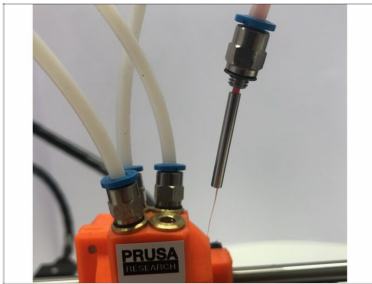

- In case filament is stuck in cooling tube pull cooling tube from filament using gentle force.
- If filaments can not be removed using gentle force use lighter to slightly warm cooling tube and using pliers pull cooling tube from filament.

STEP 3 Check smooth entry of filament

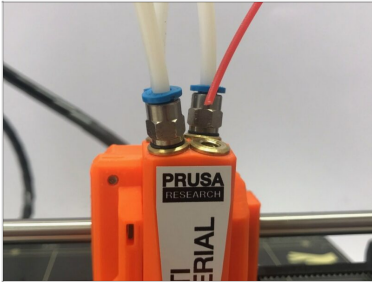

- ◆ Using piece of filament make sure filament can pass into the PTFE tube without any resistance
- ⓘ You should be able to freely insert at least 60 mm of filament.
- ◆ Check all 4 entries.

STEP 4 Filament stuck below multiplexer

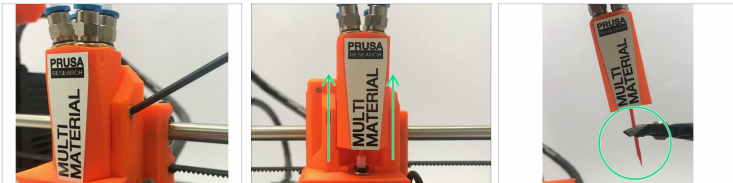

- ◆ Remove screw holding multiplexer in place.
- ◆ Slide multiplexer up to pull out filament from nozzle.
- ⓘ Pre-heat nozzle in case filament is stuck in nozzle.
- ◆ Cut end of the filament.
- ◆ Assemble multiplexer and unload filament.
