

Table of Contents

How to replace the PTFE Bowden tube (HT90)	3
.....	3
Step 1 - Introduction	4
Step 2 - Tools necessary for this guide	5
Step 3 - Protecting the print area	5
Step 4 - Disconnecting the PTFE tube	6
Step 5 - Removing the PTFE Bowden tube	
.....	7
Step 6 - New PTFE Bowden tube: parts	
preparation	7
Step 7 - Inserting the new PTFE Bowden tube	
.....	8
Step 8 - Guiding the PTFE Bowden tube	9
Step 9 - Securing the PTFE tube	10
Step 10 - Attaching the magnetic end	11
Step 11 - All done	12

How to replace the PTFE Bowden tube (HT90)



help.prusa3d.com/g907059

Scan the QR code to
display the latest
version of this
chapter.



STEP 1 Introduction

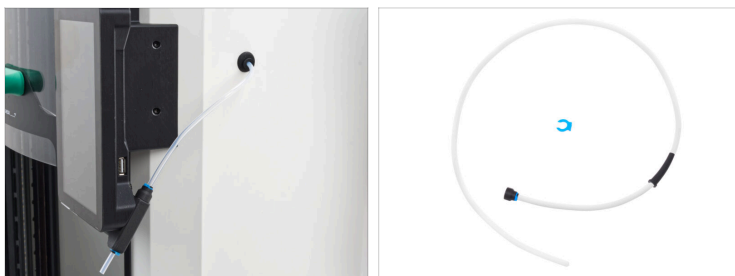

- This guide will take you through the **replacement of the PTFE Bowden tube** on the **Prusa Pro HT90**.
- All necessary parts are available in our eshop.
- ⓘ Note that you have to be logged in to have access to the spare parts section.
- ⚠ **Before you begin, ensure that:**
 - The filament is fully unloaded from the printer.
 - The printer has cooled down to room temperature.
- Turn the printer OFF.

STEP 2 Tools necessary for this guide

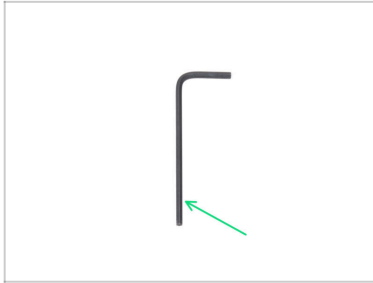

- For this guide, please prepare:
- 2.0mm Allen key

STEP 3 Protecting the print area



- ⚠ It is **highly recommended to protect the heatbed** in case any parts fall during the replacement.
- **Once the printer has cooled to room temperature**, manually move the print head to a lower position to improve access to the PTFE Bowden tube.
- Be careful not to disconnect the guide rods from the print head.
- Place an empty cardboard box (such as a Prusament box) underneath the work area to catch any falling components.

STEP 4 Disconnecting the PTFE tube



- ◆ Unlock the cable management clip that holds the cables, air tube, and PTFE Bowden tube.
- ◆ Remove the blue collet clip.
 - ◆ Do not discard this part. Keep it in a safe place for future use.
- ◆ Push down the black plastic collet to release the PTFE tube.
- ◆ Pull the PTFE tube out of the collet (printhead).

STEP 5 Removing the PTFE Bowden tube



- ◆ Pull the PTFE Bowden tube out of all the guiding rubber bands on the air tube.
- ◆ Completely pull the PTFE Bowden tube out of the printer from the outside.
- ◆ To avoid confusion with the new tube, discard this (old) one.

STEP 6 New PTFE Bowden tube: parts preparation

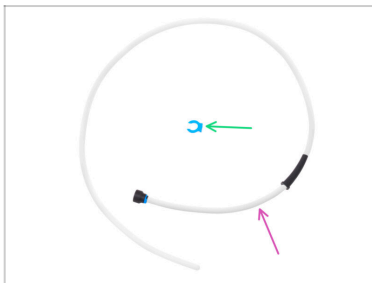

- ◆ **For the following steps, please prepare:**
- ◆ PTFE Bowden tube (1x) *new one*
- ◆ Blue collet clip (1x) *the old one can be reused*

STEP 7 Inserting the new PTFE Bowden tube



- ◆ From inside the printer, insert the long arm of the 2.0 mm Allen key through the PTFE tube guide.
- ◆ From the outside, check if the Allen key is protruding through the guide.
- ◆ Slide the PTFE tube at least 10 mm (0.4") onto the Allen key from the outside.
- ◆ Begin slowly sliding the PTFE tube into the printer.
- ◆ From inside, carefully pull the tube further in.
- ◆ Once at least 150 mm (6") of the tube is inside the printer, **remove the Allen key from the tube.**

STEP 8 Guiding the PTFE Bowden tube



- ◆ Push the PTFE tube fully into the printer enclosure.
- ◆ Guide the PTFE Bowden tube through the first rubber bend below the cable management clip.
- ◆ Guide the tube through the remaining rubber bands toward the print head.
- ◆ **Ensure the PTFE Bowden tube reaches the print head.** If it doesn't, carefully pull the tube further inside.

STEP 9 Securing the PTFE tube

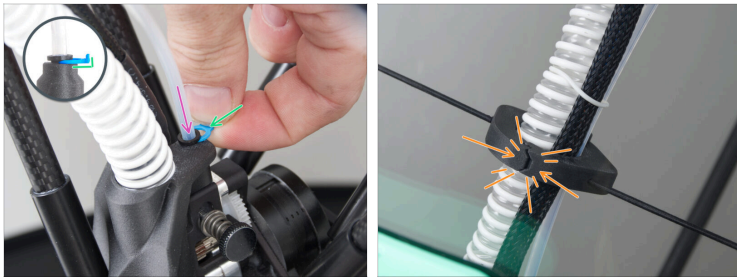

- ◆ Insert the PTFE tube **as far as it goes** into the black plastic collet in the print head.
- ⓘ **It is essential that the tube is fully inserted** to prevent any gap between the tube and the filament guide in the print head.
- ◆ Secure the collet using the blue collet clip.
 - ◆ Note the correct orientation of the part. The **notch must face upward**.
- ◆ Close the cable management clip until both ends click together securely.

STEP 10 Attaching the magnetic end



- ◆ Attach the magnetic end of the PTFE tube to the filament sensor until it snaps into place.
 - ◆ If the magnetic end does not attach properly to its counterpart or does not fully reach, **gently pull more of the tube** outward. Be careful **not to pull out the PTFE tube insert**.
 - ◆ If the magnetic end fits perfectly, the installation is complete.
 - ◆ Remove the cardboard box from the printer.

STEP 11 All done

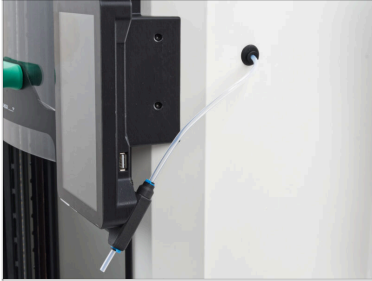

- ◆ Test by feeding filament through the entire tube to check for any snags or blockages.
- ◆ All done?
Congratulations!
You have successfully replaced the PTFE Bowden tube on your Prusa Pro HT90.
