

# Table of Contents

## Buddy3D Camera for CORE One Installation ..

3

Step 1 - Introduction .....	4
Step 2 - General Info .....	5
Step 3 - Tools Preparation .....	6
Step 4 - Parts preparation .....	7
Step 5 - Printer Preparation .....	8
Step 6 - Pre-Installed USB-C Cable .....	9
Step 7 - Side Cover Removal .....	10
Step 8 - Side Panel Removal .....	10
Step 9 - Back Cover Removal .....	11
Step 10 - Cable Guidance .....	12
Step 11 - Camera Install .....	13
Step 12 - USB-C Guidance .....	13
Step 13 - Camera Connection .....	14
Step 14 - Cable Guidance 2 .....	15
Step 15 - Rear Cover 1 .....	15
Step 16 - Rear Cover 2 .....	16
Step 17 - Side Cover Installation .....	16
Step 18 - Power Up .....	17
Step 19 - Turn Camera On .....	17
Step 20 - Prusa Connect Setup .....	18
Step 21 - Prusa Connect Setup 2 .....	18
Step 22 - Camera Setup .....	19
Step 23 - Hooray! .....	20
Step 24 - Pro Tip .....	20



# Buddy3D Camera for CORE One Installation



[help.prusa3d.com/g405529](https://help.prusa3d.com/g405529)

Scan the QR code to  
display the latest  
version of this  
chapter.



## STEP 1 Introduction



- ◆ In this guide, we will install the Buddy3D Camera into your **CORE One** printer.
- ⓘ The required camera is available on the Prusa E-shop.
- ⚠ **Before installing the camera, ensure that the printer is fully operational, connected to the Internet, and set up in **Prusa Connect**.**
- ◆ We will set up the camera using a phone with the **Prusa Mobile App** installed. Make sure to have the app installed beforehand.
- 📌 Technically, you could also use a computer and the [Connect.Prusa3D.com](https://connect.prusa3d.com) website or Prusa Connect in PrusaSlicer, but here we will focus only on the more convenient phone setup.

## STEP 2 General Info



- ◆ There are two versions of the Buddy3D camera. While both are compatible with all the current Prusa printers, only the latter is designed for the internal installation in the CORE One.
- ⓘ On CORE One, the camera is powered directly from the printer via the USB-C cable. Unfortunately, this power supply method may not be compatible with the other printer models.
- 📌 The camera transmits image using 2.4GHz Wi-Fi independently of the printer's network connection.
- 📌 The camera image can be viewed in Prusa Connect or the mobile app, after assigning the camera to a printer. The image is available only while the given printer is online too.

## STEP 3 Tools Preparation



- **Please prepare tools for this guide:**
- T10 Torx screwdriver
- Flush cutters are recommended as an optional tool.

## STEP 4 Parts preparation

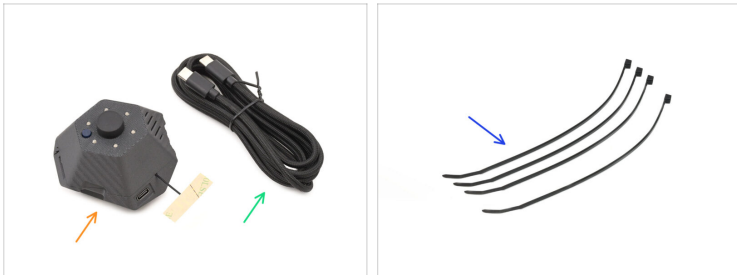

◆ For the following steps, prepare:

◆ Camera

⚠ **Important:** The protective layer on the self-adhesive antenna must not be removed. The antenna is designed to function loosely, without the need for gluing.

ⓘ Note: The camera may come with either a short or long antenna cable. This does not affect the installation or functionality.

◆ USB-C to USB-C cable

◆ Zip-tie (4x)

## STEP 5 Printer Preparation



- ◆ On the printer, visit the menu **Control** and trigger the **Auto Home**.
- ◆ Next, go to the **Move Axis** menu and move both **Y and Z** axes to **200 mm** to create more workspace inside the printer.
- ◆ Turn the printer off using the switch on the back.
- ◆ Disconnect the printer from power.

## STEP 6 Pre-Installed USB-C Cable

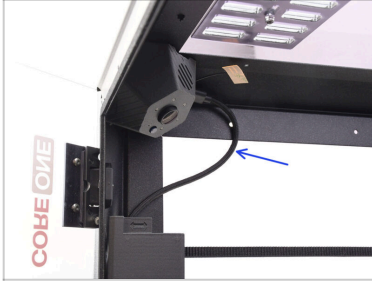

**⚠** Please check if your printer already has the USB-C cable for the camera pre-installed. Factory assembled printers since June 2025 are expected to have this cable already in-place.

**i** While we currently cannot provide specific images or detailed instructions for these pre-installed setups, we recommend visually inspecting the common USB-C port locations.

**◆** If your printer already has the cable pre-installed, skip the printer disassembly steps and proceed directly to connecting and installing the camera.

## STEP 7 Side Cover Removal

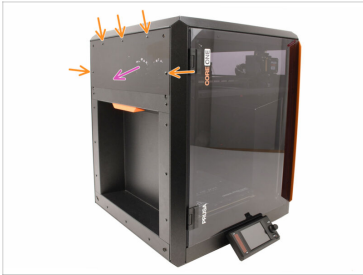

- Remove the five Nylon rivets holding the plastic side cover.
- We recommend using flush cutters to lift the top part of the rivet, unlocking it. Then, remove the bottom part of the rivet.
- Remove the plastic side cover.

---

## STEP 8 Side Panel Removal



- Remove the marked Nylon rivets holding the Side Sheet Metal Panel.
- Remove the panel.

## STEP 9 Back Cover Removal



- ◆ On the inside of the printer, remove the two screws holding the back cover.
- ◆ On the back of the printer, slide the center cover downwards.
- ◆ Pull the bottom part of the cover outward while tilting the top toward the printer. This will unhook it from the cable bundle behind.

 **Proceed carefully to avoid cutting the cables!**

## STEP 10 Cable Guidance



- ◆ We will have to guide the end of the USB-C cable along the inside of the left front metal profile on the printer.
- ◆ Take the cable and guide it through the opening in the Core XY assembly, until the connector is above the assembly.
- ⚠ Be careful not to damage any of the surrounding components.
- ⓘ Be patient, there is not much space left between the metal profiles. But in the end, the connector is able to pass through, if oriented correctly.
- ◆ Pull the connector toward the inside of the printer to keep it in place and prevent it from retracting.

## STEP 11 Camera Install



- ◆ Take the camera and remove the lens cap.
- ◆ Connect the camera to the USB-C cable on the inside of the printer.
- ◆ Mount the camera in the left front corner of the printer's frame. There is a magnet in the camera.
  - ⚠ **Note the correct orientation with the USB-C cable pointing towards the back of the printer.**
- ◆ Leave the antenna hanging freely.

## STEP 12 USB-C Guidance



- ◆ On the left side, cut off the three zip-ties securing the cable bundle below the Core XY assembly.
  - ⚠ **Proceed carefully to avoid cutting the cables!**
- ◆ Guide the end of the USB-C cable through the marked opening inside the printer, directing it toward the back.
- ◆ Pull the entire cable out from the back.

## STEP 13 Camera Connection

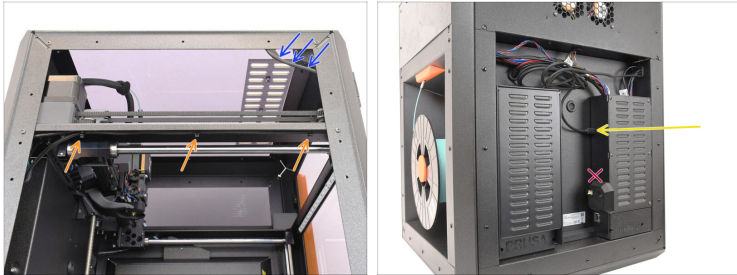

- ◆ Leave enough slack in the cable near the camera to prevent tension and to allow for easy disconnection later if needed.
  - ◆ Guide the cable bundle under and along the Core-XY rail.
  - ◆ Secure the cable bundle to the Core-XY rail using three zip-ties. Carefully cut off the excess zip-tie material.
  - ◆ On the back of the printer, connect the cable to the **UPPER USB-C connector** on the side of the electronics box.
- ⚠ **The printer has two USB-C connectors:**
- The top connector is intended for the camera and provides it with power.
  - The bottom connector is intended for diagnostics and control only as it does not provide power and cannot be used for a camera.

## STEP 14 Cable Guidance 2

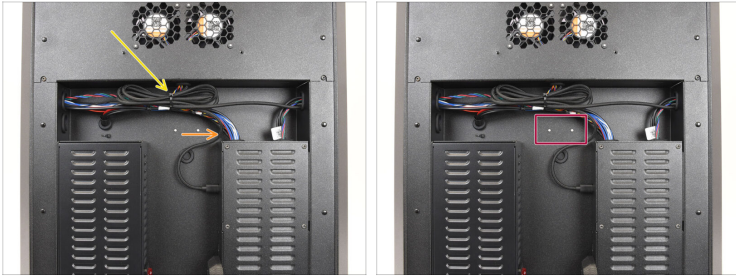

- ◆ Guide the USB-C cable near the cable bundle on the electronics side.
- ◆ Secure the remaining length of the cable to the top of the cable bundle using a zip tie.
- ⚠ Ensure enough free space around the marked area to allow for attaching a cover later.

## STEP 15 Rear Cover 1



- ◆ Add the rear cover onto the printer making sure none of the cables is getting pinched.
- ◆ Guide the USB-C cable through the dedicated mouse hole opening.

## STEP 16 Rear Cover 2



- ◆ Push the cover up, so that the four tabs engage into the recesses.
- ◆ While pushing the cover up, fix it in place using two M3x4bT screws from the inside of the printer.

## STEP 17 Side Cover Installation



- ◆ Add the side sheet metal panel to the printer and align it with the opening.
- ◆ Secure the panel in place with 11 Nylon rivets in the marked spots.
- ◆ Add the plastic cover onto the top part and align it with the opening.
- ◆ Fix it in place using 5 Nylon rivets.

## STEP 18 Power Up



- Connect the printer to power.
- Turn the printer on using the switch on the back.
- Let the printer boot up and **connect to Prusa Connect**.

---

## STEP 19 Turn Camera On



- On the printer, navigate to the Settings menu and turn the **Camera** option **ON**.

## STEP 20 Prusa Connect Setup

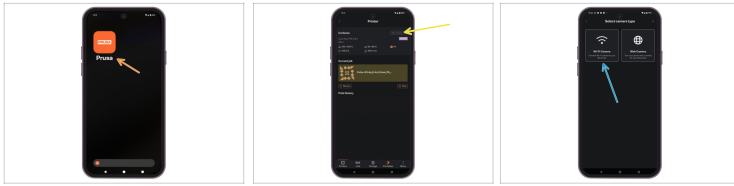

- Next, we will set the camera up using the Prusa App.
- Open the **Prusa** App on your phone.
- Open the printer detail in the App and select **Add Camera**.
- In the Camera Wizard, select the **Wi-Fi camera** option.

## STEP 21 Prusa Connect Setup 2

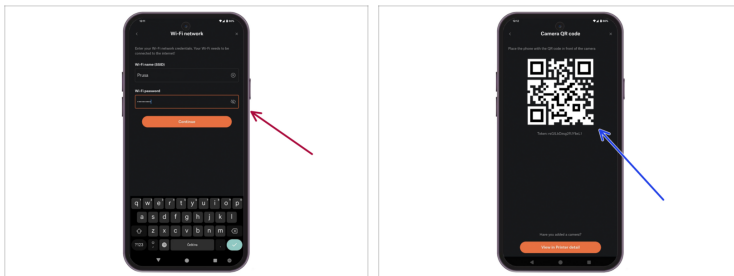

- Insert the credentials for the Wi-Fi network the camera should connect to.
- The app will generate a QR code.
  - After showing this QR code to the camera, it will automatically set itself up, connect to the specified Wi-Fi network and register with the Prusa Connect / Prusa App.

## STEP 22 Camera Setup



- On the camera body, **push the reset button**, the small protruding part next to the SD Card slot.
- ⓘ While installed in the printer, the button faces the front. You may need to slightly lift the camera to access it.
- Pushing this button will get the camera into the QR Code scanning mode.
- Show the QR code to the camera approximately from the 25cm / 10in distance.
- 📌 The camera will make a beep sound and play the "welcome jingle" after setting itself up.
- ⚠️ **There is a bug that might disable the QR code from being read, when using a dark mode. Switch the app to the light color scheme to set up the camera.**

### STEP 23 Hooray!

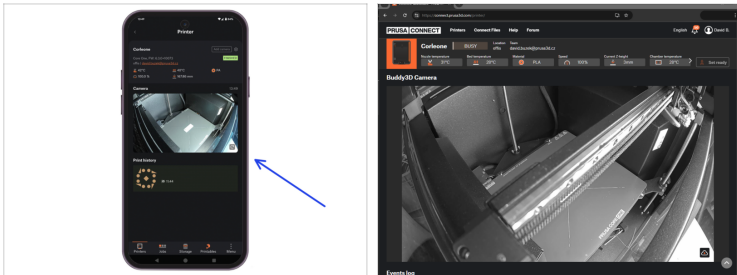

- After visiting the printer details in Prusa app or Prusa Connect, you should see the camera image.
- i** The camera image is also available in the web-based Prusa Connect or in the Prusa Connect tab in PrusaSlicer.

### STEP 24 Pro Tip

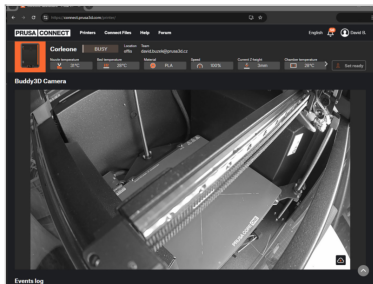

- i** The camera has been successfully installed.
- 📌** The issue of the camera image being black and white will be resolved in an upcoming camera firmware release.



---

---

---

---

---

---

---

---

---

---



---

---

---

---

---

---

---

---

---

---



---

---

---

---

---

---

---

---

---

---



---

---

---

---

---

---

---

---

---

---